



## 903-12 Metal Window Swing Lock Fitting Instructions

### Installing a Metal Window Swing Lock

To fit a Metal Window Swing Lock you will require the following tools:

- Drill
- 3.5mm drillbit
- Posidriv screwdriver
- Pencil
- Masking tape

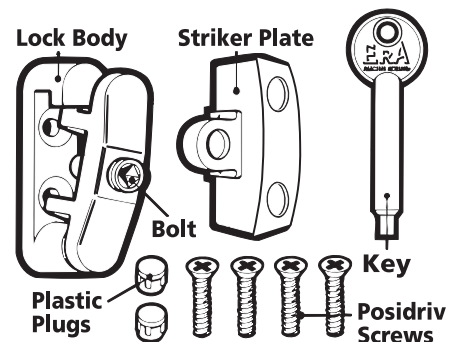

- A** Close window and select position of Metal Window Swing Lock:
- ▶ Indicate lock position
  - ▶ Alternative positions for greater security
- B** Position striker plate on fixed frame with location lug against edge of fixed frame. Mark hole positions. Apply masking tape to drill bit and drill holes to a 4mm depth. Screw striker plate to the fixed frame.
- C** Position lock body on opening frame (pivot to bottom of lock as shown in **C**) in line with striker plate. Ensure a gap of 2mm between lock body and edge of fixed frame. Mark hole positions and drill screw holes of sufficient depth to accommodate the screws.

**Caution:** Ensure that the drill depth does not touch the glass.

### Additional Information

**Operation** - Use key, screw bolt clockwise to lock. To open, screw bolt anti-clockwise and swing top section. of the lock body clear of the peg. .

**Security tip** - For extra security, drill out the drive slots in the screw head used to secure the striker plate. We recommend fitting locks to top hinged windows

**Maintenance** - Use a moist cloth only - household abrasives or solvents may affect the surface finish.

