



808-12 Locking Window Handle Fitting Instructions

Installing a Locking Window Handle

To fit a Window Locking Handle you will require the following tools:

- Bradawl (or drill with 2.5mm drill bit)
- Screwdriver
- Pencil

If fitting to hardwood, drill 2.5mm pilot holes.

- A** Remove the old window handle. Fit lockable window handle in similar location. Avoid using old screws

When using the template on windows where hinges are on the right side as you face the window, reverse template by piercing the hole centres. Offer template, 'top' uppermost with card front facing you.

Use template to mark hole positions on opening and fixed frames with bradawl.

- B** Screw striking plate into position on fixed frame (using packing plate if necessary). Insert key in locking handle. Turn anti-clockwise to unlock.

Screw handle plate into position on opening frame.

Additional Information

Operation - To open, turn key clockwise and rotate handle. Remove key. Handle automatically locks on closing, and can be locked partially open for ventilation.

Security Tips - Always close and lock windows fully shut, and remove keys from locks when leaving the house.

Maintenance - Use moist cloth only to clean all types of finish, household abrasives and solvents may affect the surface finish.

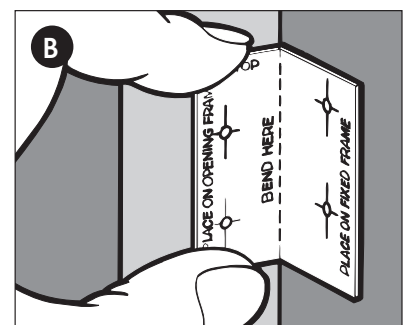
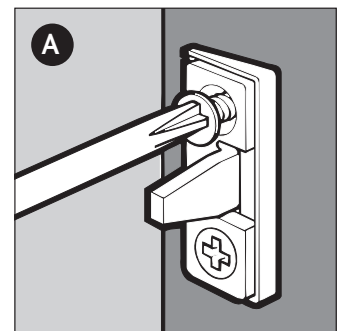
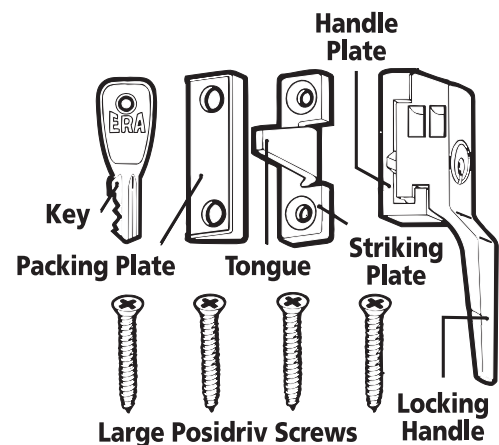

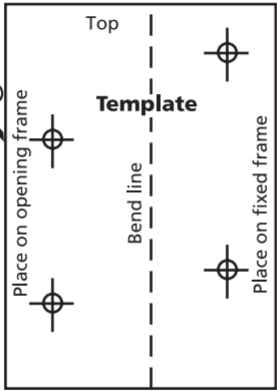

Place on opening frame

Top

Template

Bend line

Place on fixed frame