

Universal drilling template

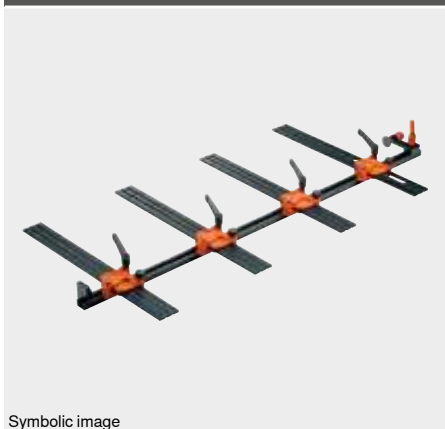

Symbolic image

- Template for pre-drilling the fixing positions for cabinet profiles, lift mechanisms, mounting and adapter plates
- The template can be used with assembled and unassembled cabinets
- Setting the height and depth position using the calibration
- Suitable for overlay and inset applications
- For system and chipboard screws
- Assembly on marking line possible
- Material: nylon/steel/aluminium/zinc

Assembly possibilities

<b>AVENTOS</b>	<b>TANDEMBOX antaro</b>
<b>CLIP top BLUMOTION</b>	<b>TANDEMBOX plus</b>
<b>CLIP top</b>	<b>METABOX</b>
<b>MODUL</b>	<b>MOVENTO</b>
<b>LEGRABOX</b>	<b>TANDEM</b>
<b>TANDEMBOX intivo</b>	<b>STANDARD</b>

Page instructions

Overview – templates 734

Overview – assembly possibilities 736

Application video

Order information

Description	Part no.
Universal drilling template	65.1000.01
<b>Composed of:</b>	
- 1 x Extension rail 1000 mm	
- 4 x Universal drilling template	
- 1 x Drilling depth spacer Ø 5 mm	
- 1 x Reducing bush Ø 5 to Ø 2.5 mm	
- 1 x Allen key	

**a** Accessories

Description	Part no.
Extension rail 2200 mm	65.7590
Universal drilling template	65.1001.01
Add-on for SPACE CORNER	65.1106

Assembly possibilities

**AVENTOS**

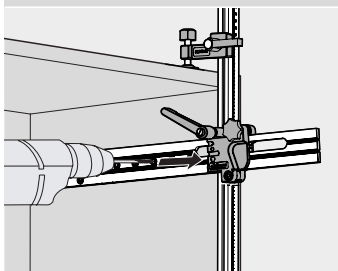

**Cabinet assembly**

- Set template height and depth position using the calibration
- Pre-drill fixing positions for lift mechanism pegs

**CLIP top BLUMOTION/CLIP top/MODUL**

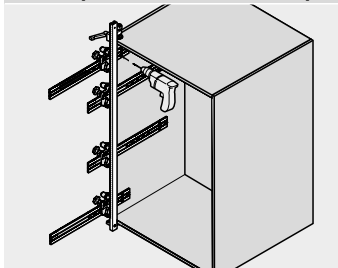

**Hinge system assembly**

- Set template height and depth position using the calibration
- Position template on cabinet
- Pre-drill fixing positions for mounting and adapter plates (BLUMOTION/TIP-ON for doors)

**LEGRABOX pure/LEGRABOX free/TANDEMBOX intivo/TANDEMBOX antaro/TANDEMBOX plus/METABOX/MOVENTO/TANDEM/STANDARD**

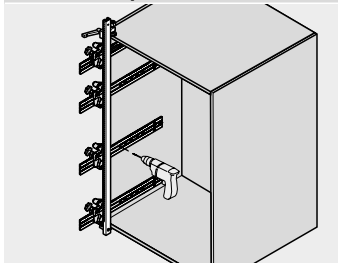

**Cabinet assembly**

- Set template height and depth position using the calibration
- Position template on cabinet
- Pre-drill fixing positions for cabinet profiles
- Pre-drill fixing positions for BLUMOTION for METABOX
- The additional part (65.1106) enables SPACE CORNER assembly