

INSET DOOR PIVOT HINGE

TTS-902

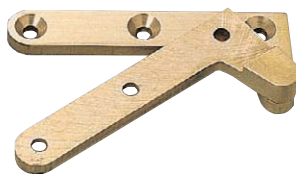

SN



PB

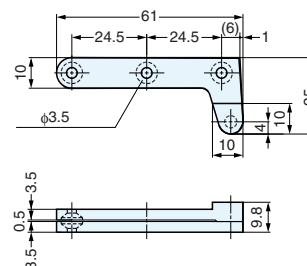

Please specify the finish when ordering.

Item No.		Box (pcs)	Material	Finish
Left	Right		Brass	Polished Brass (PB) Satin Nickel (SN)
TTS-902 L	TTS-902 R	20		

INSET DOOR PIVOT HINGE

PV-30

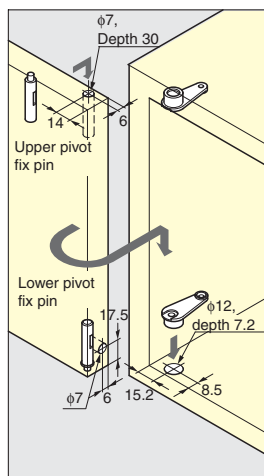

- Sold in set (upper & lower)
- Door Size: Max. W450 x H700 x T21
- Door Weight: Max. 2.6kg/pair

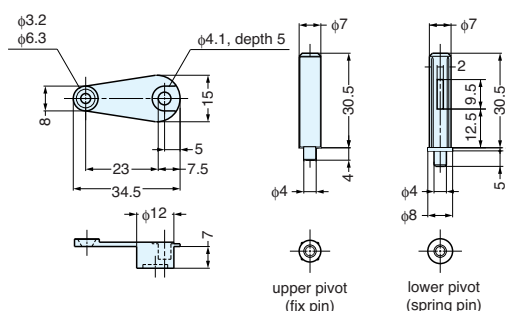

Item No.	Weight (g)	Box (pair)	Carton (pair)	Material	Finish
PV30	9	100	1000	Polyamide, Steel	White, Nickel

INSET DOOR PIVOT HINGE (ADJUSTABLE)

PH084N

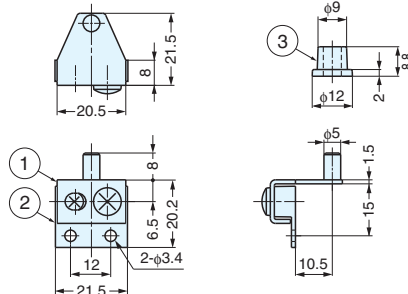
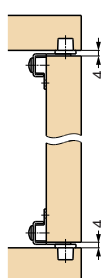

- Function to adjust horizontally and vertically
- Door Size : Max. W 300 mm x H 700 mm
- Door Thickness : 15 - 19 mm
- Door Weight : Max. 2 kg
- 2 pcs required for one door

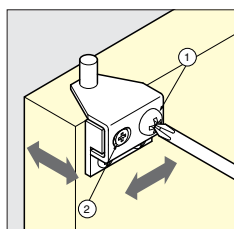

Loosen No.① screw with No.② screw adjust.
At final position tighten No.③ screw.

NO.	Part Name	Material	Finish
①	Body	Steel	Nickel
②	Mounting Plate	Zinc	Plain
③	Support	Polyamide	Black

Item No.	Weight (g)	Box (pcs)	Carton (pcs)
PH084N	16	500	1000