

Brass Hinge - Ref. 1550

Suitable for medium to heavy weight flush doors



Product features

- brass ball races running in hardened steel cups
- stainless steel pin
- brass Button Tip ends
- 10 year performance guarantee
- suitable for medium to heavy weight flush doors
- security bolt and radius corner options available

Technical data

Property	Value
Load capacity	80.0 kg
Knuckle Diameter	11.0 mm
Overall length	100.0 mm
Overall width	75.0 mm
Material thickness	4.0 mm
Screw	10.0 x 32.0 mm

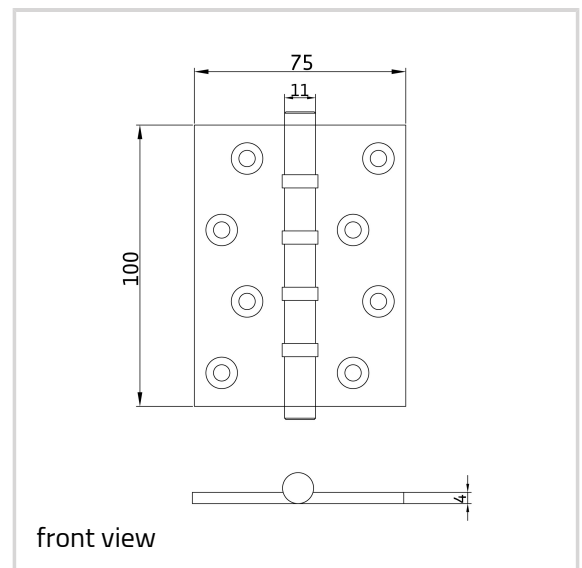

Notes

Supplied complete with pozi/slotted head brass woodscrew if required.

Brass Hinges - Brass Hinge - Ref. 1550

Item versions

Finish	Aged Brass (UK 501)
OF-No.	UK 501
VPE	10 pcs
DIN	DIN right and left hand
Article number	1550
Finish	Antique Brass (UK 502)
OF-No.	UK 502
VPE	10 pcs
DIN	DIN right and left hand
Article number	1550
Finish	Antique nickel (UK 503)
OF-No.	UK 503
VPE	10 pcs
DIN	DIN right and left hand
Article number	1550
Finish	Copper Bronze (UK 505)
OF-No.	UK 505
VPE	10 pcs
DIN	DIN right and left hand
Article number	1550
Finish	Copper (UK 506)
OF-No.	UK 506
VPE	10 pcs
DIN	DIN right and left hand
Article number	1550
Finish	Honeycombe (UK 507)
OF-No.	UK 507
VPE	10 pcs
DIN	DIN right and left hand
Article number	1550
Finish	Imitation Bronze (UK 508)
OF-No.	UK 508
VPE	10 pcs
DIN	DIN right and left hand

Brass Hinges - Brass Hinge - Ref. 1550

Article number	1550
Finish	Midnight (UK 509)
OF-No.	UK 509
VPE	10 pcs
DIN	DIN right and left hand
Article number	1550
Finish	Pearl Nickel (UK 510)
OF-No.	UK 510
VPE	10 pcs
DIN	DIN right and left hand
Article number	1550
Finish	Polished Chrome (UK 511)
OF-No.	UK 511
VPE	10 pcs
DIN	DIN right and left hand
Article number	1550
Finish	Polished & Lacquered (UK 512)
OF-No.	UK 512
VPE	10 pcs
DIN	DIN right and left hand
Article number	1550
Finish	Polished Nickel (UK 513)
OF-No.	UK 513
VPE	10 pcs
DIN	DIN right and left hand
Article number	1550
Finish	Satin Brass & Lacquered (UK 514)
OF-No.	UK 514
VPE	10 pcs
DIN	DIN right and left hand
Article number	1550
Finish	Satin Chrome (UK 515)
OF-No.	UK 515
VPE	10 pcs
DIN	DIN right and left hand
Article number	1550

Brass Hinges - Brass Hinge - Ref. 1550

Finish	Satin nickel (UK 516)
OF-No.	UK 516
VPE	10 pcs
DIN	DIN right and left hand
Article number	1550