

Hinge systems



- ▶ CLIP top BLUMOTION | CLIP top – hinges
- ▶▶ Profile door application

125° hinge

Webcode

DQDJIM



- 0-protrusion for overlay application (for cabinets with inner pull-outs or pull-out shelves)
- Hinge for **thick doors and doors with profile**
- **CLIP top BLUMOTION** with integrated **BLUMOTION** (with deactivation option)
- 125° opening angle
- 3-dimensional front adjustment
- Convenient spiral-tech depth adjustment
- Tool-free door to cabinet assembly and removal
- Suitable for special applications, e.g. mitred doors

Application

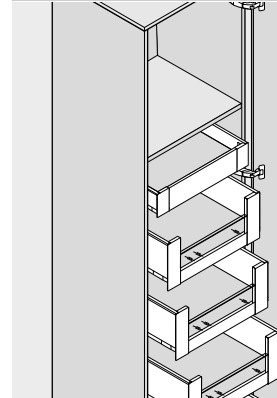

Order information

Overlay application

0-protrusion

Boss		Screw-on		
Hinge	Spring	Colour	Part no.	
CLIP top BLUMOTION	●	NI	71B7550D	
● With spring		NI Nickel plated		

Boss		Knock-in		
Hinge	Spring	Colour	Part no.	
CLIP top BLUMOTION	●	NI	71B7580D	

Accessories

Print Stamp		Logo	Colour	Part no.
Plain		–	NI	70.4503
Stamped		Blum	NI	70.4503.BP

Accessories – general

Opening angle stop		
Opening angle	Colour	Part no.
92°	R7037	70T7553
	RAL 7037 dust grey	

Chipboard screws		
Ø (mm)	Length (mm)	Part no.
3.5	15	609.1500
3.5	17	609.1700

Hinge boss cover cap		
Hinge	Colour	Part no.
CLIP top BLUMOTION	NI	70T7504
NI Nickel plated		

Hinge boss spacing		
Hinge	Spacing (mm)	Part no.
CLIP top BLUMOTION	1.5	70T3507.21

Insertion ram		
Colour	Material	Part no.
Orange	Nylon	MZM.0040

125° hinge

Webcode
DQDJIM

Planning

Hinge dimensions and gap calculation based on factory setting (mounting plate spacing = 0 mm)

Hinge and front protrusion at 90° opening angle

Overlay application
0-protrusion

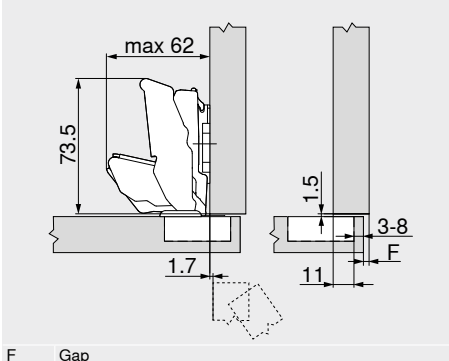
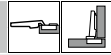

F Gap

Drilling distance TB

Front overlay FA (mm)	
MD	5 6 7 8 9 10 11 12 13 14 15 16 17 18 19
0	
3	
6	
9	
MD	Mounting plate spacing (mm)

Minimum gap F for fronts with a front radius (R = 1 mm) based on the factory setting

Drilling distance TB (mm)	Front thickness FD (mm)											
	29	30	31	32	33	34	35	36	37	38	39	40
3	0	0	0	0.1	0.3	0.7	1.2	2	2.8	4.1	5.7	-
4	0	0	0	0.1	0.4	0.8	1.5	2.3	3.4	4.9	-	-
5	0	0	0	0.1	0.4	1	1.7	2.8	4.2	-	-	-
6	0	0	0	0.1	0.6	1.2	2.1	3.5	-	-	-	-
7	0	0	0	0.2	0.7	1.6	2.8	-	-	-	-	-
8	0	0	0	0.3	1	2	-	-	-	-	-	-

We recommend a trial application for an overlay application against a wall
92° Opening angle stop

Adjustment

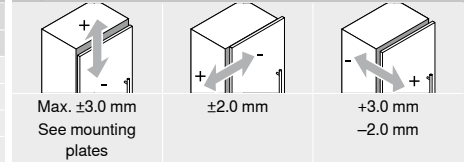

Screw-on

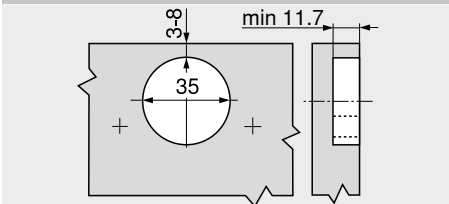

Knock-in

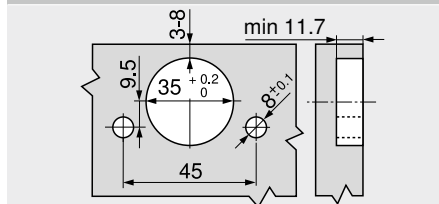

Hinge boss dimensions

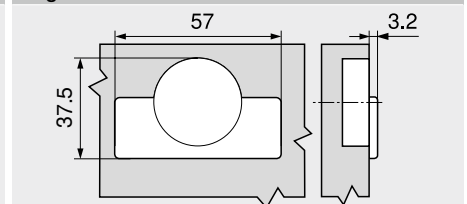

Page instructions

Overview – CLIP top BLUMOTION CLIP top – hinges	75
Mounting plates	156
Accessories – hinge arm cover cap	164
Accessories – general	166
Overview – BLUMOTION for doors	171

Overview – assembly devices
More technical details

561
662

Assembly, removal and adjustment

Short-URL
www.blum.com/a210



125° hinge

Webcode
DQDJIM

Planning

Special application

Mitred application – all 4 edges



22 mm

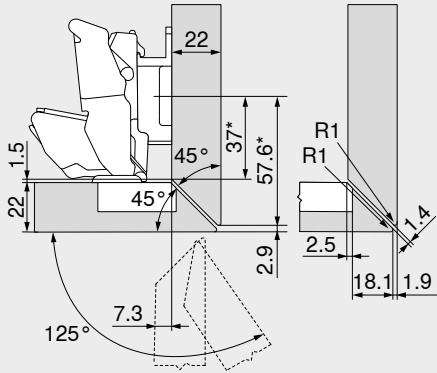

25 mm

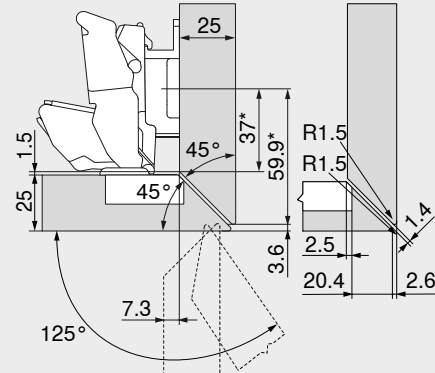

28 mm

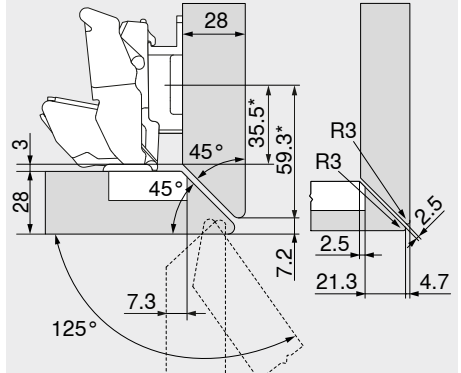

Hinge for overlay applications

* Dimension for mounting plate with dimension A = 37 mm

Description	Spacing (mm)	Part no.
Mounting plate	9	175H7190

Hinge for overlay applications

* Dimension for mounting plate with dimension A = 37 mm

Description	Spacing (mm)	Part no.
Mounting plate	9	175H7190

Hinge for overlay applications

* Dimension for mounting plate with dimension A = 37 mm

Description	Spacing (mm)	Part no.
Mounting plate	9	175H7190

Mitred application – side



22 mm

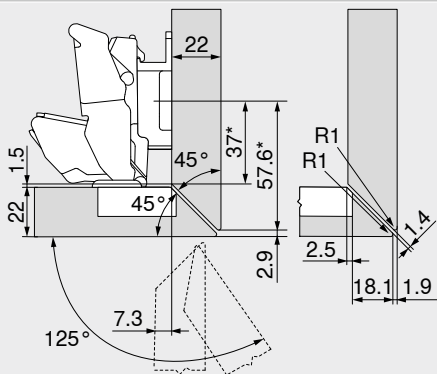

25 mm

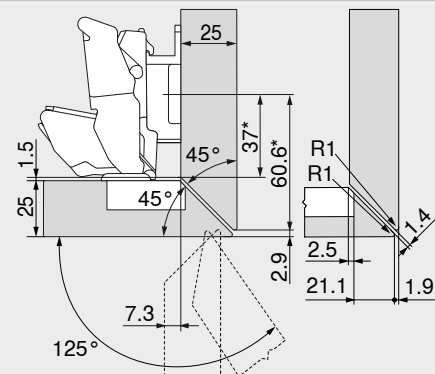

30 mm

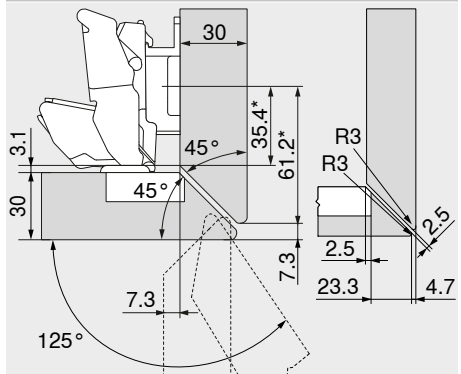

Hinge for overlay applications

* Dimension for mounting plate with dimension A = 37 mm

Description	Spacing (mm)	Part no.
Mounting plate	9	175H7190

Hinge for overlay applications

* Dimension for mounting plate with dimension A = 37 mm

Description	Spacing (mm)	Part no.
Mounting plate	9	175H7190

Hinge for overlay applications

* Dimension for mounting plate with dimension A = 37 mm

Description	Spacing (mm)	Part no.
Mounting plate	9	175H7190

125° hinge

Webcode
 DQDJIM

Planning

Special application

Mitred application – side, with large overlay



Mitred application – all 4 edges, with large overlay



Front overlay max.



19/24 mm

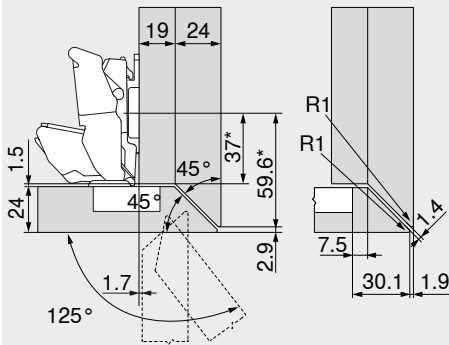

19/19 mm

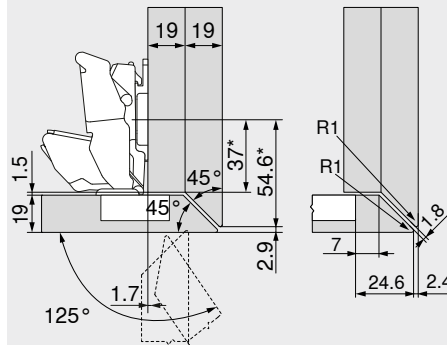

39 mm

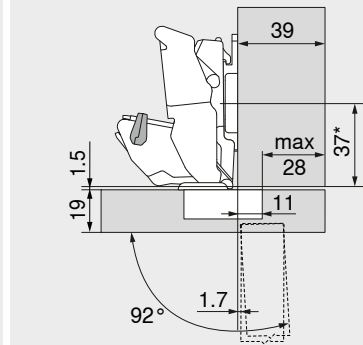

Hinge for overlay applications

Standard mounting plates with 0 mm distance

* Dimension for mounting plate with dimension A = 37 mm

Hinge for overlay applications

Standard mounting plates with 0 mm distance

* Dimension for mounting plate with dimension A = 37 mm

Hinge for overlay applications

Standard mounting plates with 0 mm distance

* Dimension for mounting plate with dimension A = 37 mm

Description	Angle	Part no.
Opening angle stop	92°	70T7553

You can select any front thickness for a free-standing cabinet.

We recommend a trial application for a neighbouring front or an overlay application on the wall.

Thin materials – protruding

16 + 6 mm

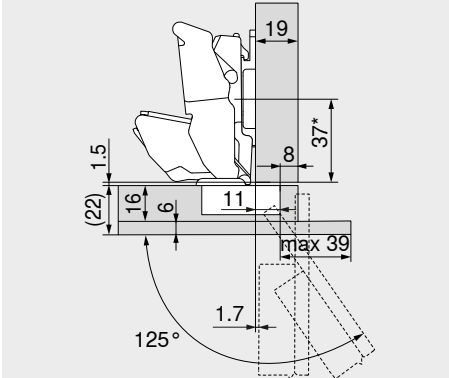

16 + 6 mm

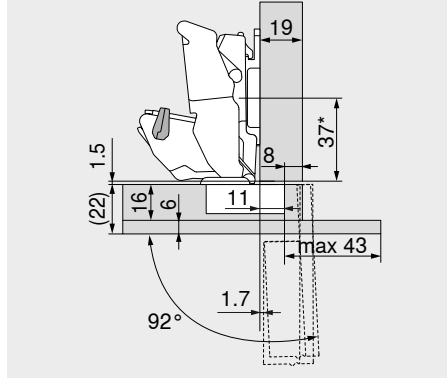

Hinge for overlay applications

Standard mounting plates with 0 mm distance

* Dimension for mounting plate with dimension A = 37 mm

Hinge for overlay applications

Standard mounting plates with 0 mm distance

* Dimension for mounting plate with dimension A = 37 mm

Description	Angle	Part no.
Opening angle stop	92°	70T7553