

Box systems



- ▶ **LEGRABOX**
- ▶▶ **Standard cabinet**

Drawer – N

Webcode

DQBMJY

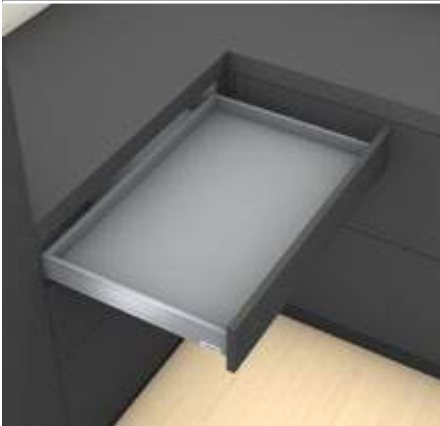

- Suitable for LEGRABOX pure and LEGRABOX free
- Steel drawer side and stainless steel
- Straight interior and exterior
- Slim drawer side 12.8 mm
- Synchronised feather-light glide
- Includes integrated, switchable **BLUMOTION S** for silent and effortless closing, and can be combined with **SERVO-DRIVE** or **TIP-ON BLUMOTION**
- Tool-free front assembly
- Two-dimensional front setting in the drawer side

Space requirement

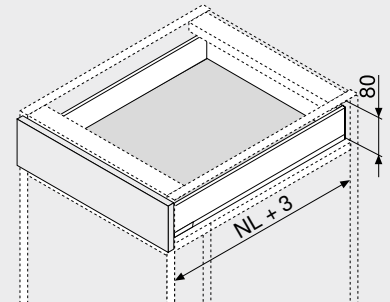

NL Nominal length

Order information

1	Cabinet profiles left/right
	BLUMOTION S
Nominal length	Dynamic carrying capacity (kg)
NL (mm)	40
400	750.4001S
450	750.4501S
500	750.5001S
550	750.5501S

2	Drawer side set	
	Drawer side height (mm) 66.5	
Nominal length	Colour	
NL (mm)	TS-M OG-M PS-M SW-M INGL	
400	770N4002S	
450	770N4502S	770N4502I
500	770N5002S	770N5002I
550	770N5502S	

Composed of:

- 2a** 1 x Left/right drawer sides
- 2b** 2 x Branding element, stamped with Blum logo, starting at 1000 pcs. individually printed
- 2c** 2 x Cover caps

3	Back fixing left/right
	Colour Material Part no.
	TS-M OG-M PS-M SW-M NI Steel ZB7N000S

4	Front fixing bracket
	Fixing method Part no.
	Screw-on 2 x ZF7N7002
	EXPANDO 2 x ZF7N70E2
	EXPANDO T 2 x ZF7N70T2

EXPANDO T suitable for thin fronts – see page instructions

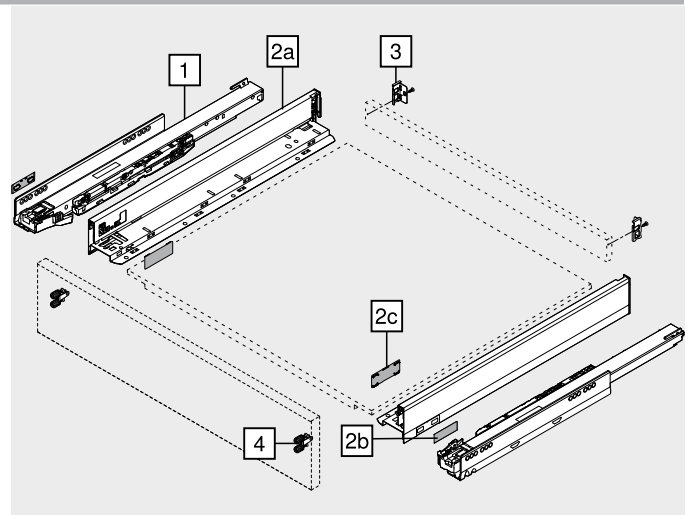

Accessories

–	Chipboard screws	Ø (mm)	Length (mm)	Part no.
		3.5	15	609.1500
		3.5	17	609.1700

For front fixing

–	Fixing screw	Ø (mm)	Length (mm)	Part no.
		4	15	61D.1500

For the connection of chipboard back fixings with chipboard back and drawer side with drawer bases

In order to achieve optimal assembly, we recommend that you use flat headed screws

Colour	Colour
TS-M Terra black matt	SW-M Silk white matt
OG-M Orion grey matt	INGL Stainless steel (Inox) Anti-fingerprint
PS-M Polar silver matt	NI Nickel plated

Drawer – N

Webcode
DQBMJY

Planning

Space requirement in cabinet	Installation dimensions – front – screw-on	Drilling distances – front – EXPANDO front	Installation dimensions – back
* +1 mm if cabinet profile is installed before the cabinet is assembled	FA Front overlay * +1 mm if cabinet profile is installed before the cabinet is assembled	* +1 mm if cabinet profile is installed before the cabinet is assembled	

Hole spacing – cabinet profiles

Cabinet profile 750 – 40 kg
Nominal length NL (mm)

400 | 450 | 500

550

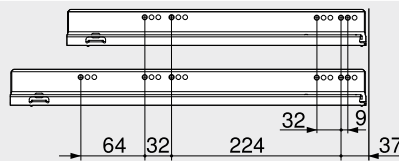

Cutting – 16 mm chipboard

<p>Back 39 mm</p>	<p>Base Chipboard back NL – 10 mm Steel back NL – 21 mm</p>	
<p>Notch dimensions</p>		<p>KB Cabinet width LW Internal cabinet width NL Nominal length</p>

Drilling distances – drawer base

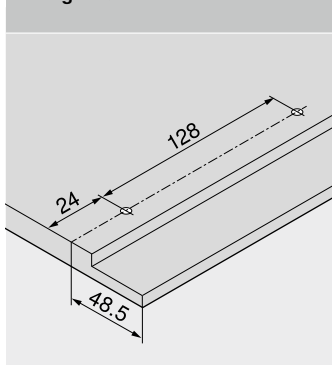

Internal cabinet depth LT min. = nominal length NL + 3 mm

Page instructions

Overview – LEGRABOX	205	Overview – TIP-ON BLUMOTION for LEGRABOX	249	More technical details	662		
Fixing system for thin fronts – EXPANDO T	554	Overview – TIP-ON for LEGRABOX CABLOXX	255	Assembly, removal and adjustment			
Assembly recommendation and limitation of liability – EXPANDO T	555	Accessories – steel back	243				
Overview – SERVO-DRIVE for LEGRABOX TANDEMBOX	321	Accessories	243				
		Cabinet profile fixing positions	247			Short-URL	
		Overview – assembly devices	561			www.blum.com/a310	