

TECHNICAL SPECIFICATION

ZNL60



CODE	FINISH
ZNL60SC	Satin Chrome
ZNL60CP	Polished Chrome
ZNL60EB	Electro Brass
ZNL60PCB	Powder Coat Black
ZNL60PCW	Powder Coat White

SUITABILITY



TECHNICAL

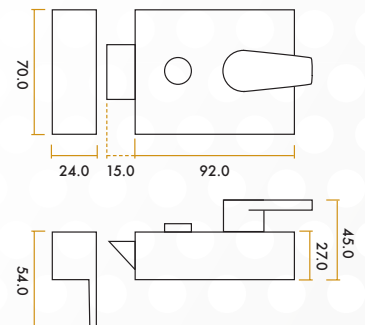

SPECIFICATIONS

- Non-deadlocking nightlatch with 60mm backset
- Bolt can be locked from inside with snib
- Dimensions: 92mm(w) x 70mm(h) x 45mm(d)
- Supplied with 5-pin rim cylinder and 3 keys
- Suitable for timber doors 35-54mm thick
- Available in 5 finishes
- Reversible

CODE	DESCRIPTION	FINISH	ADDITIONAL INFO.
ZNL60SC	Non-deadlocking night latch - 60mm backset	SC	c/w 5-pin rim cylinder
ZNL60CP	Non-deadlocking night latch - 60mm backset	CP	c/w 5-pin rim cylinder
ZNL60EB	Non-deadlocking night latch - 60mm backset	EB	c/w 5-pin rim cylinder
ZNL60PCB	Non-deadlocking night latch - 60mm backset	PCB	c/w 5-pin rim cylinder
ZNL60PCW	Non-deadlocking night latch - 60mm backset	PCW	c/w 5-pin rim cylinder



ARCHITECTURAL HARDWARE

For more information please contact us today:

Call: 01228 672900

Fax: 01228 672928

Email: sales@zoo-hardware.co.uk

Web: www.zoohardware.co.uk

Vier Design, Unit B, Dukes Drive,
Kingmoor Park North, Carlisle, Cumbria CA6 4SH



URS is a member of Registrar of Standards (Holdings) Ltd.

FITTING INSTRUCTIONS



VNL60 – NON-DEADLOCKING NIGHT LATCH

TOOLS REQUIRED • Pencil • Tape measure • Drill (with 3mm & 32mm drill bit) • Fine-toothed hacksaw • Crosshead screwdriver • 19mm chisel • Hammer

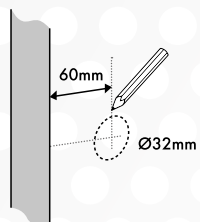

Fig. 1

1. At the required height of the door lock, using a pencil place a mark which is exactly 60mm from the edge of the door. At that point, drill a 32mm diameter hole straight through the door (Fig.1).

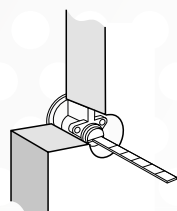

Fig. 2

2. With the key removed, insert the cylinder through the cover ring (ensuring the washer goes behind the assembly to protect the door surface) and place in the hole, ensuring the cylinder is mounted from the external side (Fig.2). Holding the mounting plate to the inside face of the door and check the projection of the flat spindle so that it projects minimum of 15mm beyond the door surface. If required, cut to size with a fine toothed hacksaw (Fig.3).

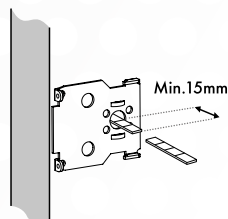

Fig. 3

3. Replace the cylinder in the door, the V5 logo should be uppermost, then from the inside secure the inner fixing plate to the door using two of the 25mm wood screws, at locations shown (Fig.4). It may be necessary to drill pilot holes using a 3mm bit to a depth of 20mm.

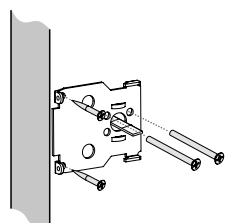

Fig. 4

4. Now the two M4 bolts are used to connect the cylinder assembly to the backplate. Insert the bolt through the top pair of holes in the inner fixing plate, locate into the cylinder assembly and tighten so all components are firmly fixed (Fig.4). On doors which are less than 45mm thick the screw will need shortened to suit.

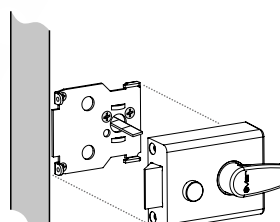

Fig. 5

5. Once the mounting plate is fixed to the door, make sure that the projection on the front of the mounting plate is 1.5mm from the door edge, this allows the latch body to sit flush to the door edge once installed.

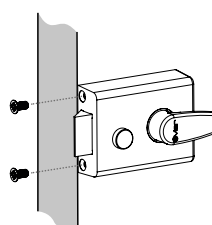

Fig. 6

6. Using the button located on the front of the case, turn the handle to withdraw the latch bolt and lock in open position using the button. Begin to align the lock body to the mounting plate ensuring that the flat connecting bar aligns and locates into the slot on the rear of the lock case (Fig.5).

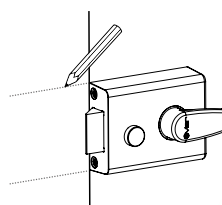

Fig. 7

7. Push the lock body firmly onto the mounting plate so that it clips firmly over the plate – slide forward slightly to lock it into position. Using the two machines screws secure the lock body to the mounting plate (Fig.6).

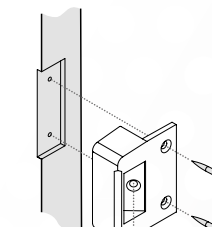

Fig. 8

8. Close the door into the frame, using the lock case as a guide, mark the position for the striker against the door frame (Fig.7). Chisel out recess in the door frame so the striker sits flush in the frame and the latch body aligns correctly to allow the latch bolt to locate securely in the striker. Then fix firmly in place with the three remaining 25mm wood screws provided (Fig.8).



For more information please contact us today:

Zoo Hardware Ltd, Unit B, Dukes Drive,
Kingmoor Park North, Carlisle, Cumbria CA6 4SH

Call: 01228 672900

Fax: 01228 672928

Email: sales@zoo-hardware.co.uk

Web: www.zoohardware.co.uk



URS is a member of Registrar of Standards (Holdings) Ltd.