

BRACKET



BT, BTK

• Stainless steel (satin finish) or steel (white or black) available



Stainless Steel

White

Black

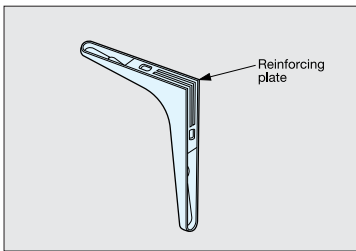
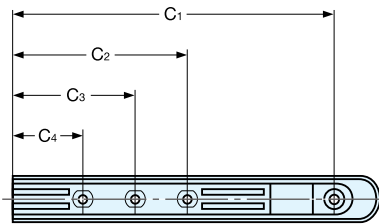

Reinforcing plate

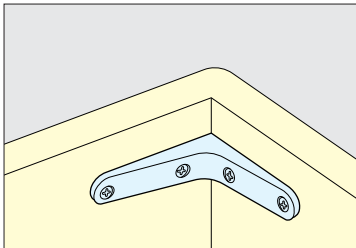

Installation

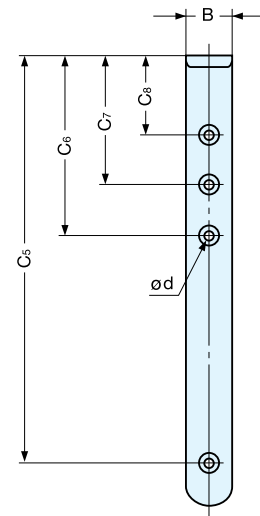
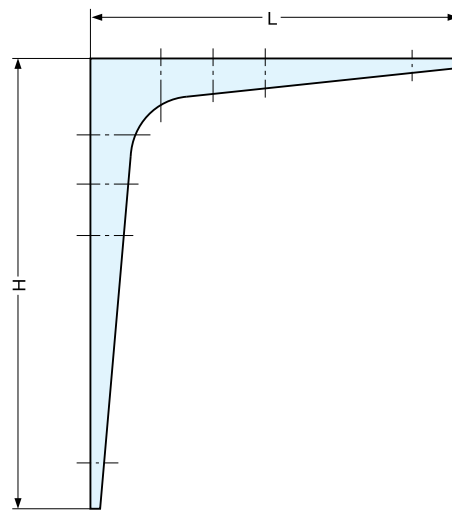

Item No.			L	H	B	C ₁	C ₂	C ₃	C ₄	C ₅	C ₆	C ₇	C ₈	d
Stainless	Steel													
BT- 85	BTK- 85B	BTK- 85W	69 (2-23/32")	86 (3-25/64")	15 (19/32")	58	27	-	-	75	26	-	-	4
BT-120	BTK-120B	BTK-120W	100 (3-15/16")	120 (4-23/32")		85	43	-	-	106	42	-	-	
BT-180	BTK-180B	BTK-180W	148.5 (5-27/32")	180.5 (7-7/64")		131	71	50	-	162.5	72.5	51.5	-	
BT-240	BTK-240B	BTK-240W	199 (7-27/32")	240 (9-29/64")	18 (23/32")	176	91	59	-	217	92	60	-	
BT-300	BTK-300B	BTK-300W	238.5 (9-25/64")	301 (11-27/32")	20 (25/32")	206.5	92.5	60.5	-	269	95	63	-	
BT-380	BTK-380B	BTK-380W	318 (12-33/64")	378 (14-7/8")	23 (29/32")	285	145	110	75	345	145	110	75	5
BT-480	BTK-480B	BTK-480W	400 (15-3/4")	480 (18-29/32")	30 (1-3/16")	360	180	135	90	440	180	135	90	5.5

Item No.			Holes	Load Capacity (kg)	Weight (g)	Box (pcs)	Carton (pcs)
Stainless	Steel						
BT- 85	BTK- 85B	BTK- 85W	4	15 (33 lbs)	40	20	240
BT-120	BTK-120B	BTK-120W		20 (44 lbs)	60		100
BT-180	BTK-180B	BTK-180W		25 (55 lbs)	110		200
BT-240	BTK-240B	BTK-240W	6	28 (61 lbs)	200	10	100
BT-300	BTK-300B	BTK-300W		35 (77 lbs)	310		40
BT-380	BTK-380B	BTK-380W		65 (143 lbs)	470		40
BT-480	BTK-480B	BTK-480W	8	82.5 (181 lbs)	1100	6	60

Material (BT)	Finish
304 Stainless Steel	Satin
Material (BTK)	Finish / Color
Steel	Black (B), White (W)