

Startec Wall bumper

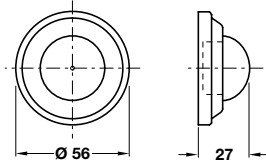

- > Wall fixing (concealed)
- > Stainless steel or brass, with rubber buffer
- > Order qty: 1 pc



937.11.700 REPLACED BY **937.14.910**
 937.00.908 REPLACED BY **937.14.918**



Finish	Cat. No.
Satin stainless steel	937.14.910
Polished brass	937.14.918

Wall bumper



- > Overall projection 12, 9.5 or 17 mm
- > Self-adhesive fixing
- > Not for use with lever handles
- > Plastic
- > Order qty: 1 pc

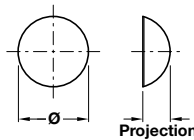

Ø x Projection	White	Black	Brown
Ø 31 x 12 mm	937.90.100	937.90.107	-
Ø 40 x 9.5 mm	937.91.400	-	937.91.446
Ø 60 x 17 mm	937.91.500	-	-

Heavy duty door stop, 38 mm projection



- > Wall fixing
- > Cast brass with black rubber bumper
- > Order qty: 1 pc

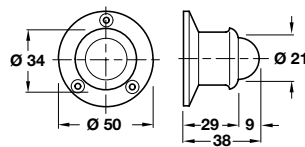

Finish	Cat. No.
Satin nickel-plated	940.09.320

Door wedge



- > Rubber
- > Order qty: 1 pc

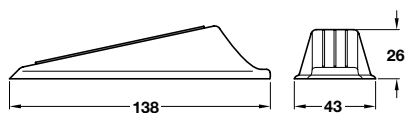

Note: ± 3 mm tolerance on non-critical dimensions



Finish	Cat. No.
Grey	938.29.005

TCH AH 2019, © Häfele U.K. Ltd 2019. Dimensional data not binding. We reserve the right to alter specifications without notice.