

HL01 Lever handle set, grade 304 stainless steel

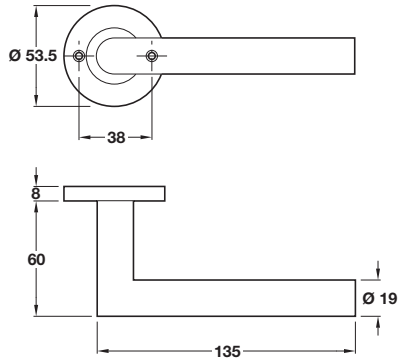

- > Pair of lever handles and roses with escutcheon or WC set included
- > Häfele branded
- > 8 mm piercing spindle included
- > Sprung, for use with standard duty followers
- > To suit doors 38-55 mm thick
- > WC release and inside turn with 8 mm spindle, suits doors 38-45 mm thick
- > Grade 304 stainless steel
- > Order qty: 1 set

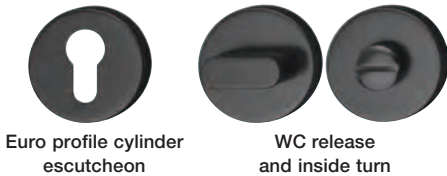

Euro profile cylinder escutcheon

WC release and inside turn

Lever handles	Graphite black
with Euro profile cylinder escutcheon	
Cat. No.	903.92.559
with WC release and inside turn	
Cat. No.	903.93.559

HL04 Lever handle set, grade 304 stainless steel

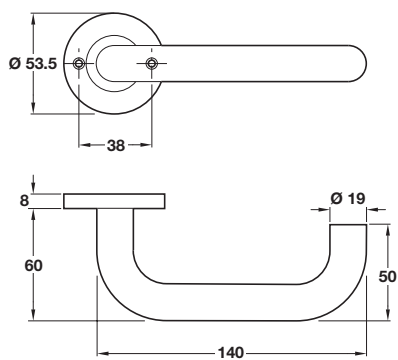

- > Pair of lever handles and roses with escutcheon or WC set included
- > Häfele branded
- > 8 mm piercing spindle included
- > Sprung, for use with standard duty followers
- > To suit doors 38-55 mm thick
- > WC/emergency release and inside turn with 8 mm spindle, suits doors 38-45 mm thick
- > Grade 304 stainless steel
- > Order qty: 1 set

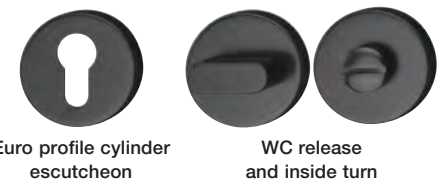

Euro profile cylinder escutcheon

WC release and inside turn

Lever handles	Graphite black
with Euro profile cylinder escutcheon	
Cat. No.	903.92.588
with WC/emergency release and inside turn	
Cat. No.	903.93.588



Most of the products you will find in this catalogue are available within 24 hours. However, to be able to offer the breadth of range in our collection, a small number of products have a longer lead time that is typically around 14 days. Please call 0800 171 2909 for an accurate delivery date when you see this symbol.