

LOOX5 12V LED 2048 DOWNLIGHT, MULTI-WHITE

The LED 2048 continuously changes the colour temperature from 2700K to 5000K, therefore creating different lighting atmospheres. The light is dimmable using Connect Mesh system with the multi-white adapter; order separately

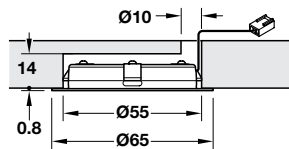

Loox5 12V LED 2048 downlight, Ø 65 mm, multi-white



- > For recess mounting, press-fit in Ø 55 mm hole
- > 0.8 mm rim, min. 14 mm hole depth required
- > For surface mounting, order bezel separately, for screw fixing
- > Voltage: 12V. Wattage: 3.0W
- > Colour temperature can be adjusted and dimmed with the Connect Mesh system and multi white adapter - order separately
- > Degree of protection: IP20
- > With 2.0 m multi-white lead with Loox5 12V connector lead
- > Steel housing
- > Order qty: 1 pc

Output:	2700-5000 K
Light colour:	Multi-white
Energy efficiency:	A+
Number of diodes:	60
Light output (Lm):	255
Wattage (W):	3.0
Efficacy (Lm/W):	85
Colour Rendering Index:	90-83

Distance	120°	2700 K	5000 K
250 mm		290 Lx	345 Lx
500 mm		110 Lx	130 Lx
750 mm		60 Lx	70 Lx
1000 mm		40 Lx	45 Lx



Order bezel separately for surface mounting, shown below



Control using Häfele Connect Mesh system, shown from page 5.178

5 12V						
Finish	2700-5000 K					
Polished chrome-plated	833.72.401					
Silver coloured	833.72.402					
Stainless steel coloured	833.72.403					

Loox5 LED 2020 / 2047 / 2048 / 3038 / 3039 bezel, Ø 66.5 mm

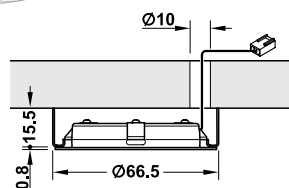

- > For surface mounting Loox LED 2020 / 2047 / 2048 / 3038 / 3039 downlights
- > Screw fixing
- > Zinc alloy
- > Order qty: 1 pc



Finish	Cat. No.
Polished chrome plated	833.72.802
Silver coloured	833.72.803
Stainless steel coloured	833.72.804

YOU ALSO NEED:



PAGE AMENDED
10.06.21/2