

GRASS NEXIS 110° HINGES

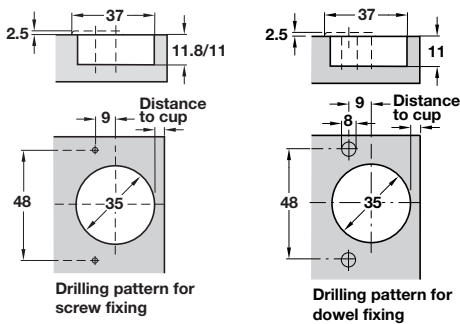

- > Opening angle 110° (can be reduced to 85° using angle restrictor, see page 104)
- > Full overlay or half overlay/twin mounting
- > Sprung
- > Ø 35 mm cup
- > For door thickness up to 22 mm see table below
- > Screw fixing or dowel fixing cup
- > Click on arms
- > Soft close compatible
- > Nickel-plated pressed steel cup and arm
- > Order fixing screws separately for screw fixing versions
- > Order qty: 1 pc



110° Hinge

Door thickness mm	Distance to cup E mm				
	3.0	4.0	5.0	6.0	7.0
16	0.5	0.5	0.5	0.5	0.5
18	1.0	1.0	1.0	1.0	1.0
19	1.2	1.2	1.2	1.2	1.2
20	2.2	1.5	1.5	1.5	1.5
22	4.7	3.7	2.8	2.1	2.1
Minimum gap					

Grass Nexis 110° concealed hinge, full overlay mounting

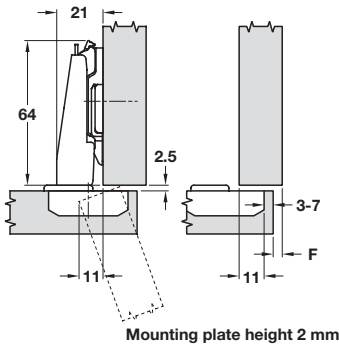

Door overlay mm							
14	15	16	17	18	19	20	
			4	5	6	7	0
	4	5	6	7			2
Distance to cup E mm				Mounting plate distance mm			



Fixing	Click on
Screw fixing	322.17.530
Dowel fixing	322.17.580

Grass Nexis 110° concealed hinge, half overlay/twin mounting

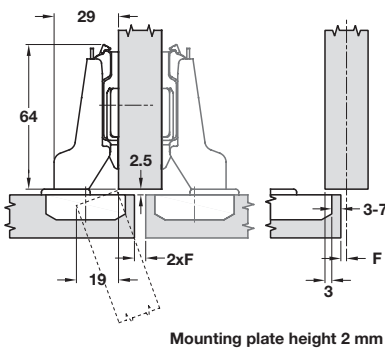

Door overlay mm							
5	6	7	8	9	10	11	
				4	5	6	0
			4	5	6		2
Distance to cup E mm				Mounting plate distance mm			



Fixing	Click on
Screw fixing	322.17.531

YOU ALSO NEED:

MOUNTING PLATES
Pages 100-102

FIXING SCREWS
Section 13 page 88

OPTIONAL ACCESSORIES
Pages 103-105, 109-121

MOUNTING PLATES FOR NEXIS CLICK ON HINGES



Nexis click on hinges are shown on pages **72-89**

Grass Nexis super compact cruciform mounting plate

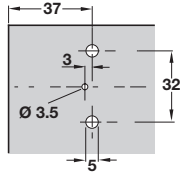
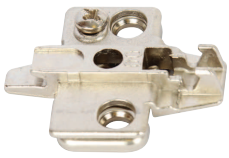

For Varianta screws

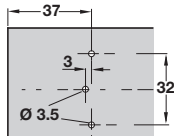

For Hospa screws

- > For click on systems
- > Varianta or Hospa screw fixing
- > Two part plate with external height adjustment
- > Nickel-plated zinc alloy and pressed steel
- > Order fixing screws separately
- > Order qty: 1 pc



Height	Varianta screws	Hospa screw
0 mm	322.86.750	322.85.750
2 mm	322.86.752	322.85.752
4 mm	322.86.754	322.85.754
8 mm	322.86.758	322.85.758
18 mm	322.86.759	322.85.759



Information on mounting plate adjustment is shown on page **33**

Grass Nexis cruciform mounting plate

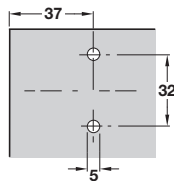

With pre-mounted Euro screws

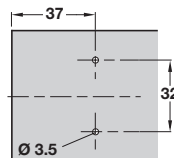

For Hospa screws

- > For click on systems
- > With pre mounted euro screws or Hospa screw fixing
- > One part plate with external height adjustment
- > Nickel-plated pressed steel
- > Order fixing screws separately for Hospa screw fixing versions
- > Order qty: 1 pc



Height	Pre-mounted Euro screws	Hospa screw
0 mm	322.94.710	322.94.700
2 mm	322.94.712	322.94.702
4 mm	322.94.714	322.94.704

Grass Nexis cruciform cam adjusting mounting plate

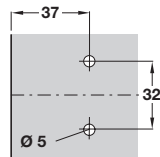
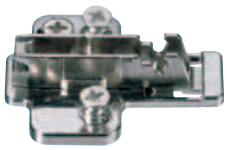

With pre-mounted Euro screws

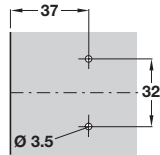
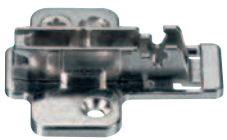

For Hospa screws

- > For click on systems
- > With pre-mounted Euro screws or Hospa screw fixing
- > Two part plate, eccentric cam adjusting
- > Nickel-plated zinc alloy
- > Order fixing screws separately for Hospa screw fixing versions
- > Order qty: 1 pc



Height	Pre-mounted Euro screws	Hospa screw
0 mm	322.89.720	322.89.700
2 mm	322.89.722	322.89.702
4 mm	-	322.89.704
8 mm	-	322.89.708

Grass Nexis straight cam adjusting mounting plate

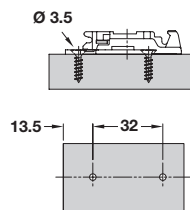

- > For click on systems
- > Hospa screw fixing
- > Two part plate, eccentric cam adjusting
- > Nickel-plated zinc alloy
- > Order fixing screws separately
- > Order qty: 1 pc



Height	Hospa screw
0 mm	322.72.720
2 mm	322.72.722
4 mm	322.72.724

GRASS MOUNTING PLATES FOR NEXIS SLIDE ON HINGES



Nexis slide on hinges are shown on pages **72-89**

Grass Nexis super compact cruciform mounting plate

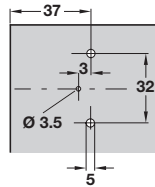

For Varianta screws

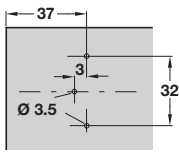
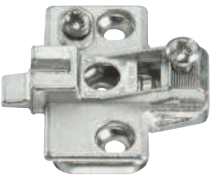

For Hospa screws

- > For slide on systems
- > Varianta or Hospa screw fixing
- > Two part plate with external height adjustment
- > Nickel-plated zinc alloy and pressed steel
- > Order fixing screws separately
- > Order qty: 1 pc



Height	Varianta screws	Hospa screw
0 mm	323.86.708	323.85.701
2 mm	-	323.85.729
4 mm	323.86.744	323.85.747



Information on mounting plate adjustment is shown on page **33**

Grass Nexis super compact cruciform mounting plate

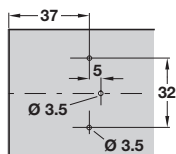
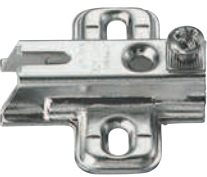

For Hospa screws

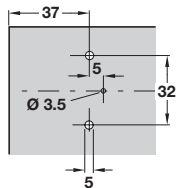
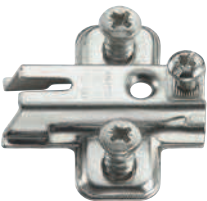

With pre-mounted Euro screws

- > For slide on systems
- > With Pre-mounted Euro screws or Hospa screw fixing
- > One part plate with external height adjustment
- > Nickel-plated pressed steel
- > Order fixing screws separately for Hospa screw fixing versions
- > Order qty: 1 pc



Height	Pre-mounted Euro screws	Hospa screw
0 mm	323.84.704	323.83.707
2 mm	323.84.722	323.83.725
4 mm	323.84.740	323.83.743

Grass Nexis straight mounting plate

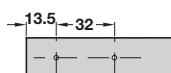

- > For slide on systems
- > Hospa screw fixing
- > Two part plate with internal height adjustment
- > Nickel-plated zinc alloy and pressed steel
- > Order fixing screws separately
- > Order qty: 1 pc



Height	Hospa screw
0 mm	323.71.707
2 mm	323.71.725
4 mm	323.71.743

GRASS COVER PLATES FOR NEXIS HINGES



Nexis slide on hinges are shown on pages **72-89**

Grass hinge cup cover cap

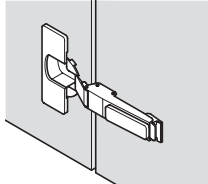

- > For use with Ø 35 mm cup hinges shown on pages **72-85**
- > Covers screw fixing hinge cup of those hinges without soft close for aesthetic appearance
- > No fixing materials required, clips onto hinge cup
- > Zinc alloy
- > Order qty: 1 pc

GRASS
25
YEAR
WARRANTY

Finish	Cat. No.
Nickel-plated	322.67.191

Grass hinge arm cover plate



- > Please note: Cover plate to match full overlay hinge is not soft close compatible
- > Nickel-plated steel
- > Order qty: 1 pc

GRASS
25
YEAR
WARRANTY

To match	Full overlay	Half overlay
Cat. No.	323.68.300	323.68.310

ACCESSORIES AND INSTALLATION TOOLS FOR NEXIS HINGES

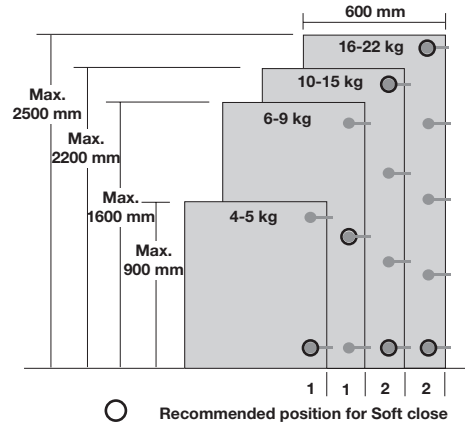

Nexis hinges are shown on pages **72-89**

9

Furniture Hinges and Flap Fittings: Hinges

Grass soft close fitting, for screw fixing cup

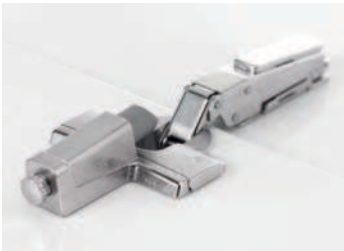

- > For use with 95°/100°/110°/125°/45°/30°/post/-24°/-14° sprung concealed hinges with screw fixing cup
- > The quantity and position of soft close will depend on door height and weight, see chart above
- > No fixing materials required, clips onto hinge cup
- > Zinc alloy
- > Order qty: 1 pc



Finish	Cat. No.
Nickel-plated	322.67.190

Grass soft close fitting, for screw fixing cup



- > For use with sprung 170° concealed hinges with screw or dowel fixing cup - shown on page **78-79**
- > The quantity and position of soft close will depend on door height and weight, see chart above
- > No fixing materials required, clips onto hinge arm
- > Zinc alloy
- > Order qty: 1 pc



Finish	Cat. No.
Nickel-plated	322.67.170

Grass opening angle reduction clip for 170° hinge



- > For use with sprung 170° concealed hinges - shown on page **78-79**
- > Reduces the opening angle to 120°
- > Prevents doors from colliding with the cabinet side in inset or mitred corner applications
- > Black plastic
- > Order qty: 1 pc



Cat. No.
For use with 170° hinge

Grass opening angle reduction clip for 110° hinge



- > Reduces the opening angle to 85°
- > Prevents doors from colliding with fronts or walls in corner applications
- > For use with 110° hinges shown on page **76**
- > Black plastic
- > Order qty: 1 pc



Cat. No.
For use with 110° hinge

TOH TECHNOLOGY 2018, © Hafele U.K., Ltd 2018. Dimensional data not binding. We reserve the right to alter specifications without notice.

Grass jig for mounting plates and hinges



- > For use with all Click on hinges and mounting plates
- > For overlay installation only
- > Reversible
- > Black plastic
- > Order qty: 1 pc

	Cat. No.
Mounting plate jig	001.33.160

Grass drilling jig 500



- > For drilling holes for hinges with either screw fixing or pre-mounted euro screws
- > With template for wing mounting plate
- > Bit for hand drill machine
- > 2x drill Ø 8 mm
- > 1x drill Ø 35 mm
- > Bit for boring machine
- > Order qty: 1 pc

GRASS
25
YEAR
WARRANTY

Drilling pattern	Cat. No.
48/9	001.33.400

Grass mounting plate jig



- > Available to order separately
- > Order qty: 1 pc

GRASS
25
YEAR
WARRANTY

	Cat. No.
Mounting plate jig	001.33.420

TCH TECHNOLOGY 2018, © Häfele U.K. Ltd 2018. Dimensional data not binding. We reserve the right to alter specifications without notice.